

HG 02 GL DP S / HG 02 GL DP C TECHNICAL SPECIFICATIONS

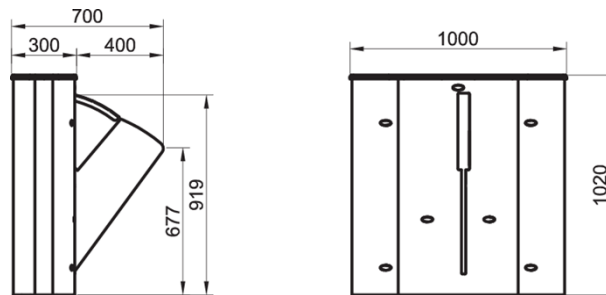

HG 02 GL DP-S: SINGLE UNIT (LEFT or RIGHT)



HG 02 GL DP-C: CENTER UNIT (COMBO)

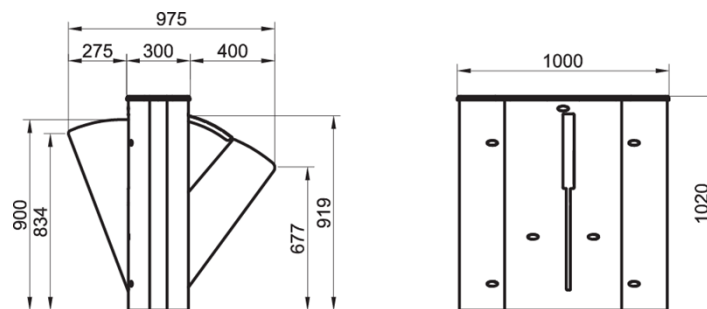

Power Requirements : 110/220 - 240V. 60/50Hz. AC (%±10) 24V.DC
 Single Unit : At standby ~10W. During operation ~39W.
 Center Unit : At standby ~20W. During operation ~78W

Dimensions : Single Unit :1000 x 1020 x 300 + wing length (400) mm
 Center Unit :1000 x 1020 x 300 + wing length (400+275) mm

Passage Width : Compatible with wheelchair, luggage, trolley usage thanks to 900mm passage width.

Wing Features : RGB LED illuminated 10 mm impact resistant tempered glass, coloured acrylic wings. (opt. polycarbon).

Top Lid : Tempered glass top lid (opt. other materials)

Body Features : The body is made of 304-grade (Opt. 316-grade) satin finished stainless steel.

Indicator & Display Features

HG 02 GL DP S / HG 02 GL DP C

TECHNICAL SPECIFICATIONS

: An illuminated acrylic layer under the glass top lid is included. At standby, the acrylic layer illuminated in blue; during authorised passages it flashes green; when an unauthorized attempt is detected or during alert mode it flashes red. (opt. sliding asteroid animated indicator on top lid)

Operating Temperature, Humidity, IP Rating, MCBF

: -20°C to +68°C / RH 95% non-condensing / IP 44 indoor model / 1M cycles

Control System

: All inputs are opto-coupler protected . Compatible with all access control systems that provide dry contact or grounding outputs. Optional RS232/RS485/TCP IP control module is available.

System Features & Operation

: Electronically controlled rapid wing movement for quick and smooth bi-directional passages. Internal dip switch selectable free passage by photocell detection, restricted access, controlled access on both or single direction modes are built in features.

Output Data

: The system provides dry contact passage feedback by relays.

Emergency Mode

: System allows free passage in emergency mode and in case of power failure (powered by internal back-up battery).

Flow Rate

: Wing opening speed/time: 0,5 sec. wing closing speed/time: 0,5 sec.
Nominal: ~30 - 60 passages/minute (recommended reference figure).
❖ Utilisation of different access control units can change the flow rate.

Standard Features

: RGB LED illuminated status indicators, tempered glass top lid.

Optional Accessories and Applications

: Sliding asteroid animated indicator on top lid, remote control unit, manual control, coin slot/intelligent coin system and coin box, counter, card reader pole, photocell alarm sensor, interface unit for PC, RS485, RS232 and LAN, audio-messaging system, base plate, separator.

Note

: A passage lane consists of min. 2 pieces of single units facing each other.

**Design and specifications are subject to change without notice.*

